

# Roof element multiple span

...

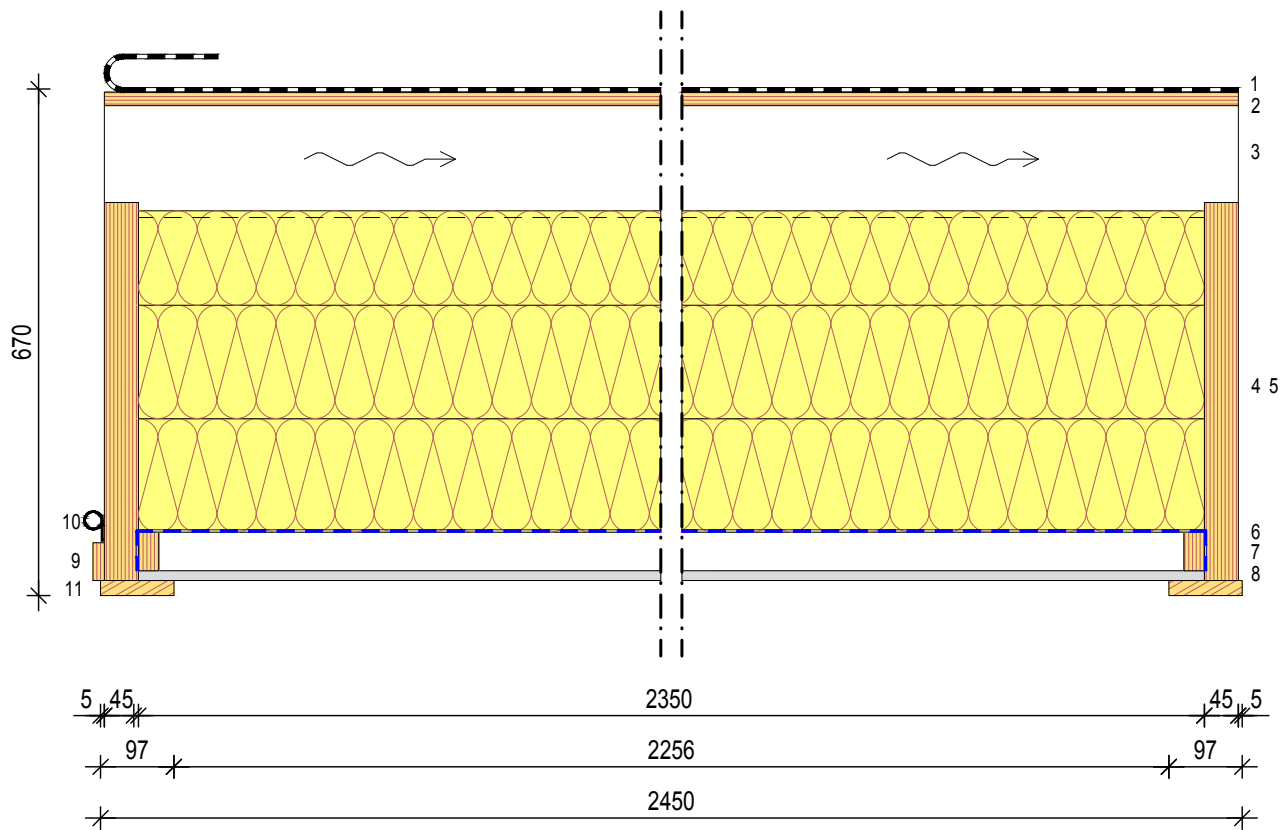

## STRUCTURAL LAYERS

1. Roofing
2. 18 mm Metsä Wood Spruce plywood TG2
3. 42x148 C24 purlins c/c 800 + air gap
4. 45x500 Kerto-S rafters
5. 425 mm mineral wool insulation (A2-s1, d0)
6. Water vapor membrane
7. 51x60 Kerto-S battens c/c 400
8. 13 mm gypsum plaster board (A2-s1, d0, K<sub>2</sub>,10)
9. 15x50 plywood strips
10. EPDM seal
11. 20x97 timber battens

## TECHNICAL SPECIFICATIONS

- Category: Roof element
- Key benefit: Cost efficient long free span with less material consumption
- Economical span: 7 m
- Resistance to fire class: R 30
- Thickness: 670 mm
- Airborne sound reduction factor: -
- Thermal properties: U-value 0,09 W/m<sup>2</sup>K