

RIPA floor element

...

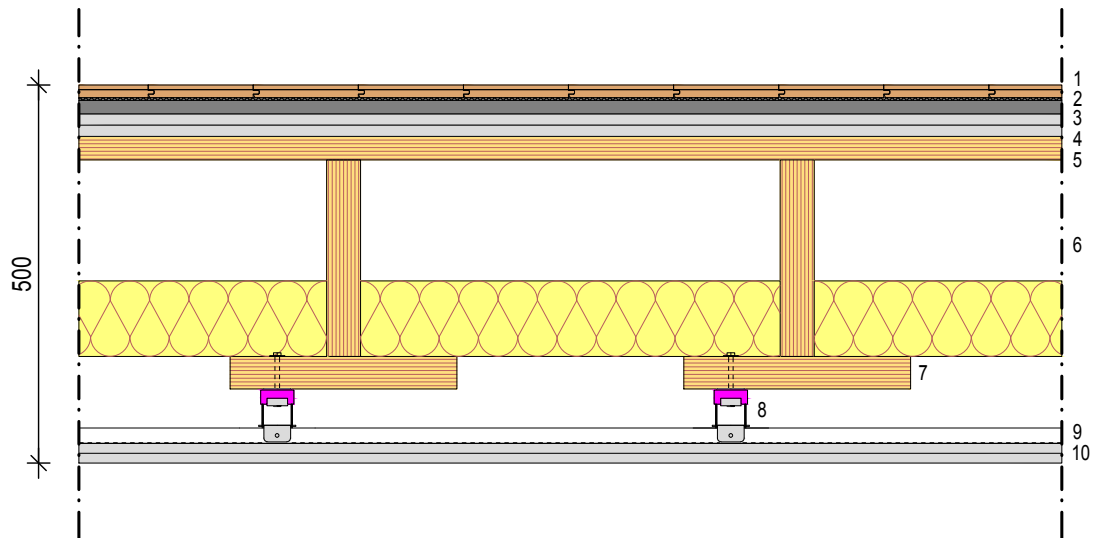

STRUCTURAL LAYERS

1. Parquet or laminate flooring
2. Impact sound insulation layer
3. 18 mm gypsum fibre board (A2-s1, d0, K₂30)
4. 2x15 mm gypsum plaster boards
5. 31 mm Kerto-Q top panel (structurally glued)
6. 45x260 Kerto-S ribs c/c 815 + rock wool insulation
7. 43x300 Kerto-S flanges (structurally glued)
8. Acoustic suspenders
9. Battens c/c 400
10. 2x13 mm gypsum plaster boards (A2-s1, d0, K₂30)

TECHNICAL SPECIFICATIONS

- Category: Floor element (intermediate)
- Key benefit: Cost efficient long free span with less material consumption
- Economical span: 6 m
- Resistance to fire class: REI 60
- Thickness: 500 mm
- Airborne sound reduction factor: $R_w' \geq 55$ dB
- Impact sound transmission factor: $L_{n'w} \leq 53$ dB